



J-DRain

300 / 302 / 1000

3904 Virginia Ave • Cincinnati, Ohio 45227 • Phone (513) 271-6000 • Fax (513) 271-4420

Geonet Drainage Composites

J-DRain 300, 302 & 1000 consist of an HDPE geonet drainage core with a filter fabric bonded to one or both sides. The geonet drainage core is literally crush proof, yet it is flexible enough to conform to irregular surfaces. Because of their crushproof nature, geonet drainage composites can be used in the most extreme cases with heavy loads and/or heavy vehicular traffic.



J-DRain 300 consists of a heavy duty, high density, and polyethylene geonet drainage core with its ridges heat fused to a layer of nonwoven filter fabric. The filter fabric retains soil or sand particles as well as freshly placed concrete or grout, allowing filtered water to pass through to the drainage core. J-DRain 300 provides drainage from one side only.

J-DRain 302 is identical to J-DRain 300 in physical properties with the addition of a layer of filter fabric to the backside, providing drainage and filtration from both sides.

J-DRain 1000 is identical to J-DRain 300 in physical properties with the addition of a layer of heavy-duty grey fabric bonded to the backside providing protection and cushion for waterproofing systems requiring a protection layer.

CORE	TEST METHOD	ENGLISH	METRIC
Compressive Strength	ASTM D-1621	40,000 psf	1,917 kNm ²
Thickness	ASTM D-1777	.22 inches	5.6 mm
Flow (Hydraulic Gradient = 1)	ASTM D-4716	8.5 g/min/ft	106 L/min/m
FABRIC	TEST METHOD	300/302/1000 (front)	300/302/1000 (grey back)
Flow	ASTM D-4491	135 gal/min/ft ² 5,500 L/min/m ²	110 gal/min/ft ² 4,477 L/min/m ²
Puncture	ASTM D-4833	65 lbs (.30 kN)	95 lbs .42 kN
Apparent Opening Size	ASTM D-4751	70 US Sieve .212 mm	70 US Sieve .212 mm
Grab Tensile	ASTM D-4632	120lbs .53 kN	160 lbs .71 kN

Roll Dimensions: 300/ 302: 4' x 75' (75 / 80 lbs) 1000: 4' x 50' (55 lbs)

The above information is to the best of our knowledge accurate, but is not intended to be considered as a guarantee. Any implied warranty for a particular use or purpose is excluded. If the Product does not meet the above properties, and notice is given to US Fabrics, Inc., the product will be replaced or refunded. (1/2009).

J-DRain Geonet Applications

Foundation Walls
 Retaining Walls
 Planters & Roof Gardens
 Bridge Abutments
 Under Slabs

FOUNDATION WALL / RETAINING WALL

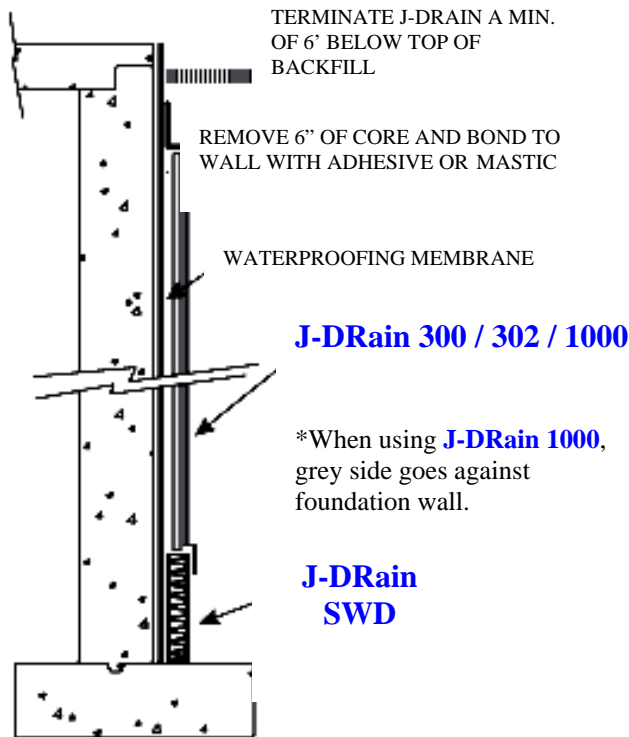

PLANTERS & ROOF GARDENS

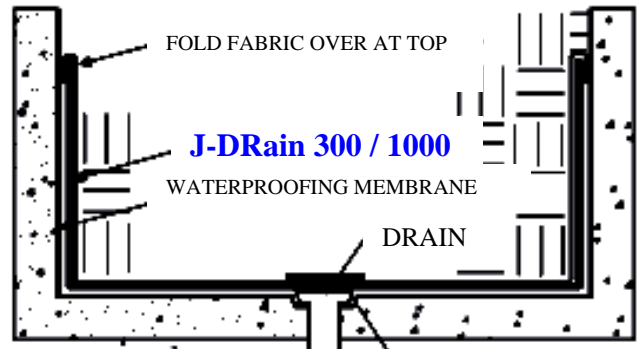

NOTE: When using **J-DRain 1000** cut and remove bottom layer of grey fabric so water can pass into drain.

PLAZA DECKS

