



# J-DRain 200 Series

3904 Virginia Ave • Cincinnati, Ohio 45227 • Phone (513) 271-6000 • Fax (513) 271-4420

## Prefabricated Drainage Composite

**J-DRain 200** Series performs a multi-faceted role by providing protection for waterproofing systems and managing sub-surface water around building foundations. A filter fabric retains the soil backfill and provides hydrostatic relief by allowing water to pass into the drainage core. The collected water is then conveyed to the **J-DRain SWD-6** or **SWD-12** collection systems.

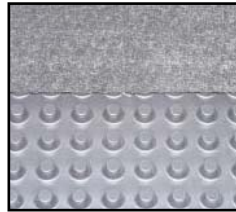

**J-DRain 200** consists of a light-duty impermeable polymeric sheet cusped under heat and pressure to form a high-flow dimpled drainage core. The core is then bonded to a layer of non-woven fabric. The filter fabric retains soil or sand particles as well as freshly placed concrete or grout, allowing filtered water to pass into the drainage core. Please limit to 20 feet of backfill.

**J-DRain 220** has the identical properties as J-DRain 200 with the addition of a protection sheet bonded to the back side of the cusped core providing protection for soft membrane waterproofing systems. J-DRain 220 is comparable with waterproofing systems minus the use of a protection board. Please limit to 20 feet of backfill.

CORE	TEST METHOD	ENGLISH	METRIC
Compressive Strength	ASTM D-1621	11,000 psf	528 kNm <sup>2</sup>
Thickness	ASTM D-1777	.25 in	.635 cm
Flow Hydraulic Gradient = 1	ASTM D-4716	11.5 gpm/ft width	141 lpm/m width
FABRIC	TEST METHOD	ENGLISH	METRIC
Flow	ASTM D-4491	140 gpm/ft <sup>2</sup>	5698 lpm/m <sup>2</sup>
Puncture	ASTM D-4833	65 lbs	.30 kN
Apparent Opening Size	ASTM D-4751	70 US Sieve	.212 mm
Grab Tensile	ASTM D-4632	100 lbs	.45 kN

Roll Dimensions: 4' x 50' (40 lbs)

The above information is to the best of our knowledge accurate, but is not intended to be considered as a guarantee. Any implied warranty for a particular use or purpose is excluded. If the Product does not meet the above properties, and notice is given to US Fabrics, Inc., the product will be replaced or refunded. (1/2009).

# J-DRain 200 Series Applications

Basement Foundations  
Retaining Walls  
Planters  
Bridge Abutments

Should not be used on foundations exceeding 20' in height

## FOUNDATION WALL / RETAINING WALL

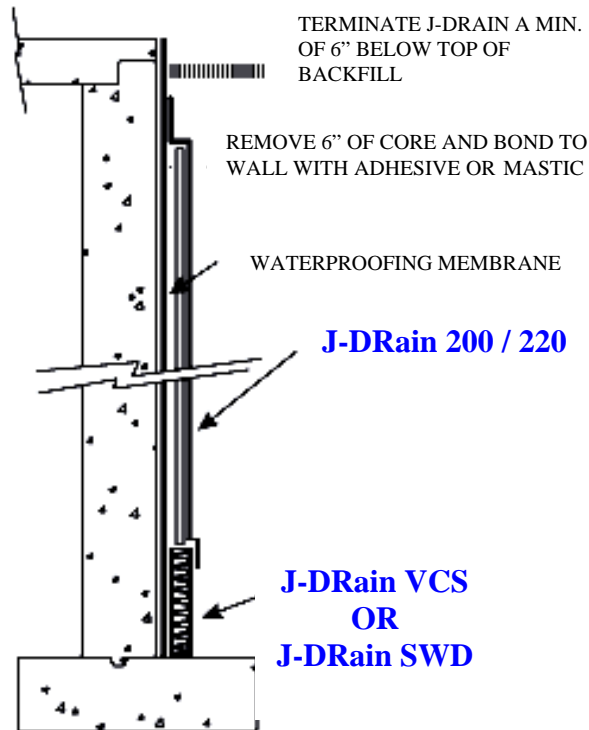

## PLANTERS & ROOF GARDENS

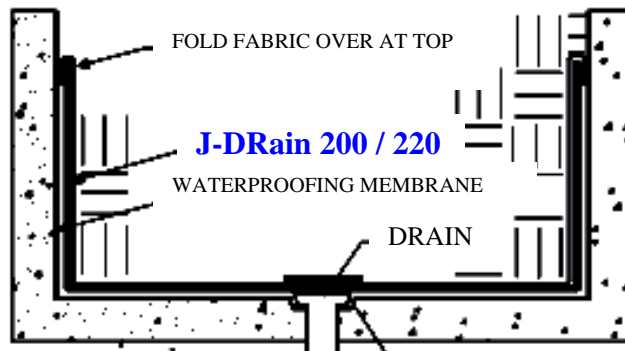

NOTE: When using J-DRain 200 / 220 cut and remove drainage core and cover with an aluminum plate as shown.



3904 Virginia Ave • Cincinnati, OH 45227 • Phone (513) 271-6000 • Fax (513) 271-4420

[www.usfabricsinc.com](http://www.usfabricsinc.com)