



# J-DRain 700 Series

3904 Virginia Ave • Cincinnati, Ohio 45227 • Phone (513) 271-6000 • Fax (513) 271-4420

## Prefabricated Drainage Composite

**J-DRain 700** Series performs a multi-faceted role by providing protection for waterproofing systems collecting excess water in planters, roof top gardens and horizontal surfaces. The collected water is then conveyed to **J-DRain SWD-6** or **SWD-12** or other proper collection system.

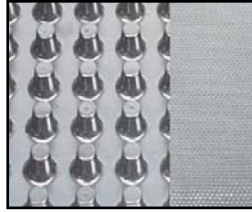

**J-DRain 700** consists of a heavy-duty impermeable polymeric sheet cusped under heat and pressure to form a high-flow dimpled drainage core. The core is then bonded to a layer of woven fabric. The filter fabric retains soil or sand particles as well as freshly placed concrete or grout, allowing filtered water to pass into the drainage core.

**J-DRain 720** has the identical properties as J-DRain 700 with the addition of a protection sheet bonded to the back side of the cusped core providing protection for soft membrane waterproofing systems. J-DRain 720 is compatible with waterproofing minus the use of a protection board.

**J-DRain 740** consists of a heavy duty impermeable polymeric cusped sheet bonded to a layer of 4.0 oz/sy nonwoven filter fabric.

700/720/740 CORE	TEST METHOD	ENGLISH	METRIC
Compressive Strength	ASTM D-1621	21,000 psf	1005 KnM <sup>2</sup>
Thickness	ASTM D-1777	.40 in	10.16 Mm
Flow Hydraulic Gradient = 1	ASTM D-4716	21 gpm/ft width	260 lpm/m width
700/720 FABRIC	TEST METHOD	ENGLISH	METRIC
Flow	ASTM D-4491	145 gpm/ft <sup>2</sup>	5907 lpm/m <sup>2</sup>
Puncture	ASTM D-4833	100 lbs	.44 kN
Apparent Opening Size	ASTM D-4751	40 US Sieve	.425 mm
Grab Tensile	ASTM D-4632	365 lbs	1.62 kN
740 FABRIC	TEST METHOD	ENGLISH	METRIC
Flow	ASTM D-4491	140 gpm/ft <sup>2</sup>	5704 lpm/m <sup>2</sup>
Puncture	ASTM D-4833	65 lbs	.30 kN
Apparent Opening Size	ASTM D-4751	70 US Sieve	.211 mm
Grab Tensile	ASTM D-4632	100 lbs	.45 kN

Roll Dimensions: 4' x 50' (50 lbs)

The above information is to the best of our knowledge accurate, but is not intended to be considered as a guarantee. Any implied warranty for a particular use or purpose is excluded. If the Product does not meet the above properties, and notice is given to US Fabrics, Inc., the product will be replaced or refunded. (1/2009).

# J-DRain 700 Series Applications

Planters & Roof Gardens  
 Roof Gardens  
 Plaza Decks  
 Split-Slabs

## PLAZA DECKS

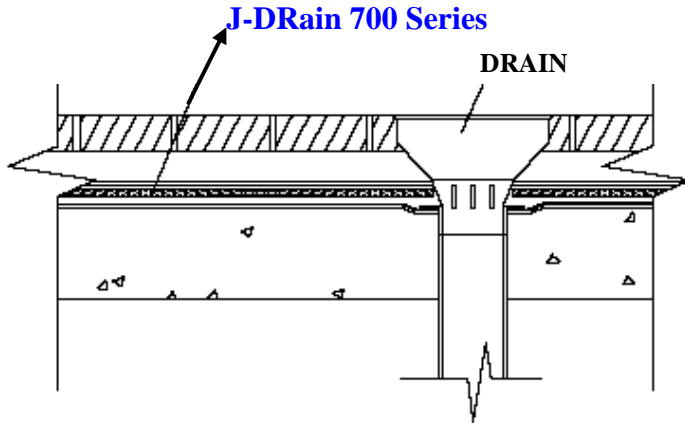

## PLANTERS & ROOF GARDENS

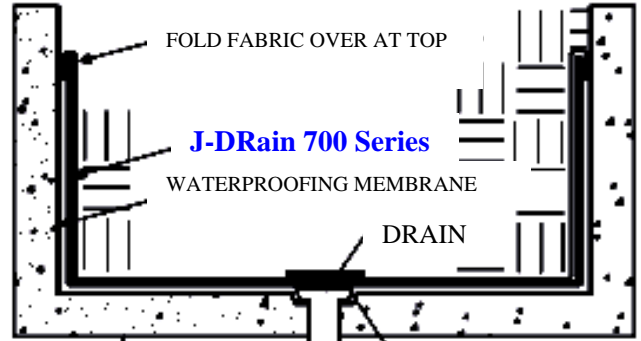

NOTE: When using J-DRain 700 Series cut and remove drainage core and cover with an aluminum plate as shown.

## SPLIT-SLAB

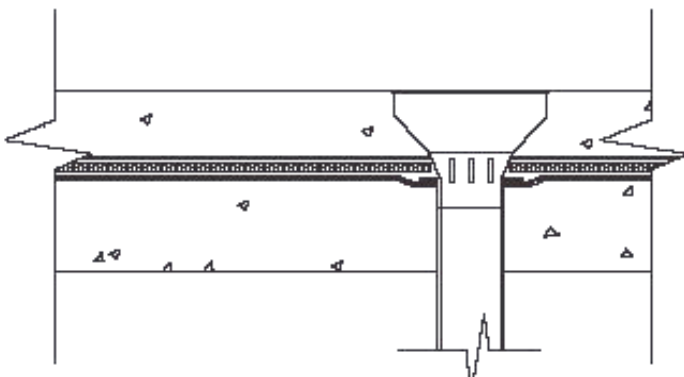

## FOUNDATION / RETAINING WALL

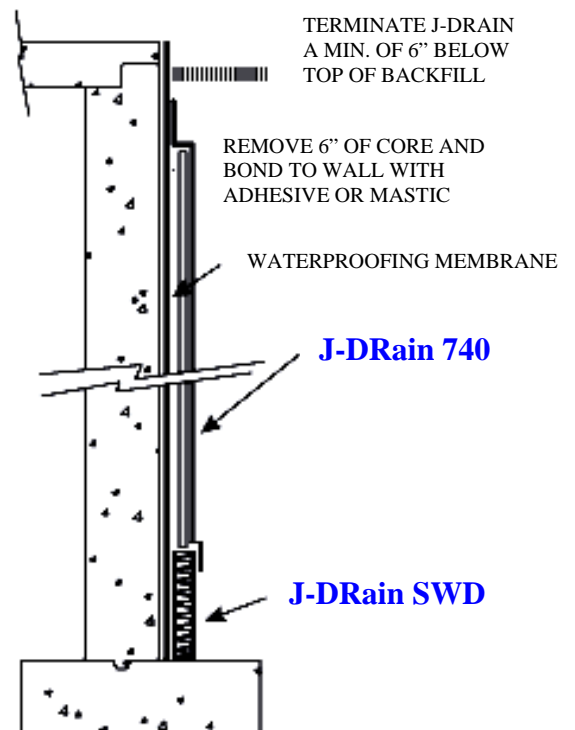

3904 Virginia Ave • Cincinnati, OH 45227 • Phone (513) 271-6000 • Fax (513) 271-4420

[www.usfabricsinc.com](http://www.usfabricsinc.com)